

इंटरनेट

मानक

Disclosure to Promote the Right To Information

Whereas the Parliament of India has set out to provide a practical regime of right to information for citizens to secure access to information under the control of public authorities, in order to promote transparency and accountability in the working of every public authority, and whereas the attached publication of the Bureau of Indian Standards is of particular interest to the public, particularly disadvantaged communities and those engaged in the pursuit of education and knowledge, the attached public safety standard is made available to promote the timely dissemination of this information in an accurate manner to the public.

“जानने का अधिकार, जीने का अधिकार”

Mazdoor Kisan Shakti Sangathan

“The Right to Information, The Right to Live”

“पुराने को छोड़ नये के तरफ”

Jawaharlal Nehru

“Step Out From the Old to the New”

IS 206 (2010): Tee and Strap Hinges - Specification [CED
15: Builder Hardware]

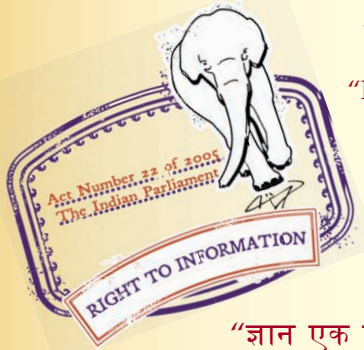

“ज्ञान से एक नये भारत का निर्माण”

Satyanarayan Gangaram Pitroda

“Invent a New India Using Knowledge”



“ज्ञान एक ऐसा खजाना है जो कभी चुराया नहीं जा सकता है”

Bhartrhari—Nitiśatakam

“Knowledge is such a treasure which cannot be stolen”

BLANK PAGE



भारतीय मानक
टी और पट्टा कब्जे — विशिष्टि
(पांचवाँ पुनरीक्षण)

Indian Standard
TEE AND STRAP HINGES — SPECIFICATION
(*Fifth Revision*)

ICS 77.140.20; 91.190

© BIS 2010

BUREAU OF INDIAN STANDARDS
MANAK BHAVAN, 9 BAHADUR SHAH ZAFAR MARG
NEW DELHI 110002

FOREWORD

This Indian Standard (Fifth Revision) was adopted by the Bureau of Indian Standards, after the draft finalized by the Builder's Hardware Sectional Committee had been approved by the Civil Engineering Division Council.

Tee hinges are used in garden or big wooden plank doors, whereas strap hinges are used in boxes to strengthen their corners, in addition to big wooden gate doors. This standard was first published in 1950 and subsequently revised in 1962, 1973, 1981 and 1992.

The present revision is being issued in light of the comments received during use of the standard. In this revision the following modifications have been incorporated:

- a) Additional types of hinges introduced for both tee and strap hinges, thereby enlarging the scope of the standard,
- b) Dimensional requirements have been modified, and
- c) General up-dating in respect of applicable material standards.

This standard contains provision (*see 7*) which permit the purchaser to use his option for selection to suit his requirements.

The composition of the Committee responsible for the formulation of this standard is given in Annex B.

For the purpose of deciding whether a particular requirement of this standard is complied with, the final value, observed or calculated, expressing the result of a test or analysis, shall be rounded off in accordance with IS 2 : 1960 'Rules for rounding off numerical values (*revised*)'. The number of significant places retained in the rounded off value should be the same as that of the specified value in this standard.

Indian Standard

TEE AND STRAP HINGES — SPECIFICATION

(Fifth Revision)

1 SCOPE

This standard lays down requirements for mild steel tee and strap hinges that are commonly used in general building construction.

2 REFERENCES

The standards listed below contain provisions which through reference in this text, constitute provisions of this standard. At the time of publication, the editions indicated were valid. All standards are subject to revision and parties to agreements based on this standard are encouraged to investigate the possibility of applying the most recent editions of the standards indicated below:

<i>IS No.</i>	<i>Title</i>
280 : 2006	Mild steel wire for general engineering purposes (<i>fourth revision</i>)
1079 : 1994	Hot rolled carbon steel sheets and strips – Specification (<i>fifth revision</i>)
6760 : 1972	Specification for slotted countersunk head wood screws

3 TYPES

3.1 Tee hinges shall be of the following types:

<i>Type</i>	<i>Designation</i>	<i>Ref to Table</i>	<i>Ref to Fig.</i>
1	Light weight (Type 1)	2	1
2	Light weight (Type 2)	3	1
3	Medium weight (Type 1)	4	1
4	Medium weight (Type 2)	5	1
5	Heavy weight (Type 1)	6	1
6	Heavy weight (Type 2)	7	1
7	Heavy weight (Type 3)	8	1

3.2 Strap hinges shall be of the following types:

<i>Type</i>	<i>Designation</i>	<i>Ref to Table</i>	<i>Ref to Fig.</i>
1	Light weight	9	2
2	Medium weight (Type 1)	10	2
3	Medium weight (Type 2)	11	2
4	Heavy weight	12	2

4 MATERIAL

Material used for manufacture of tee and strap hinges shall comply with the requirements given in Table 1.

Table 1 Requirements of Materials for Tee and Strap Hinges

SI No.	Material	Suitable Grade in Indian Standard
(1)	(2)	(3)
i)	Mild steel sheet	Grade 0 of IS 1079
ii)	Mild steel wire	Min ¼ H of IS 280

5 DIMENSIONS AND TOLERANCES

5.1 The leading dimensions of the various types of tee and strap hinges and tolerances thereon shall conform to those given in Tables 2 to 12 read with Fig. 1 and Fig. 2

5.1.1 The size of the hinges shall be designated by the dimension *A* (*see* Fig. 1 and Fig. 2).

6 WORKMANSHIP

Hinges shall be well made, free from burrs, flaws and defects of any kind. The movement shall be square, and the working shall be free and easy, without any play or shake. The hole for the hinge pin shall be central to the boss; firm and riveted over, so that the heads are well formed. All screw holes shall be clean and countersunk and shall be suitable for countersunk head wood screws (*see* IS 6760) of the numbers specified in Tables 2 to 12 for different types and sizes of hinges.

7 FINISH

Tee and strap hinges shall be either bright finished or stove enameled black, as specified by the purchaser.

8 PACKING

8.1 Hinges shall be packed in cardboard boxes or in any other approved packing in the following quantities:

Size up to and including 125 mm	: 20 pieces in each package
Sizes 150 mm and above	: 10 pieces in each package

NOTE — Hinges may be packed in multiples of six, if required by the purchaser.

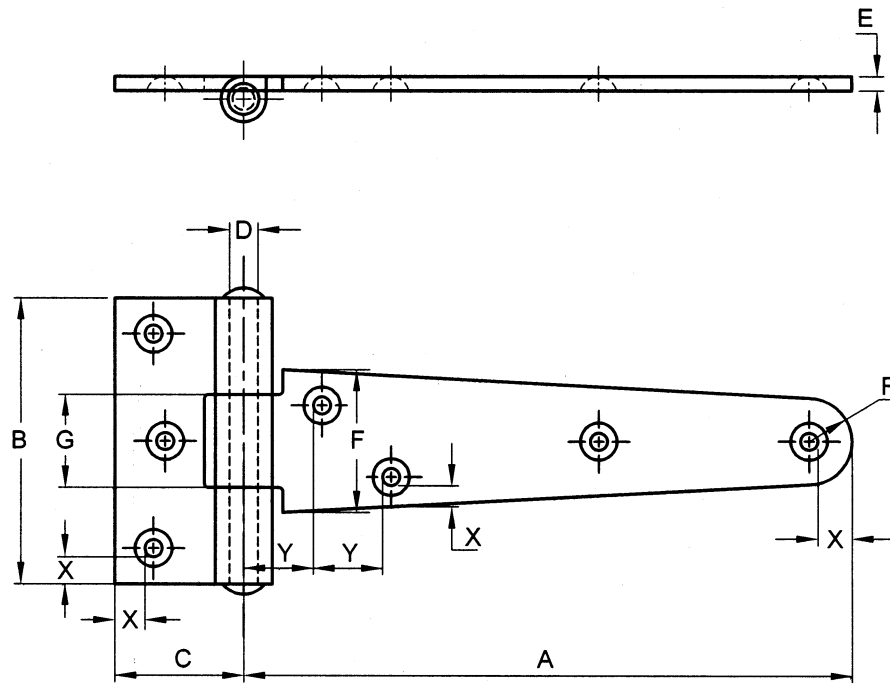

FIG. 1 TYPICAL MILD STEEL TEE HINGES

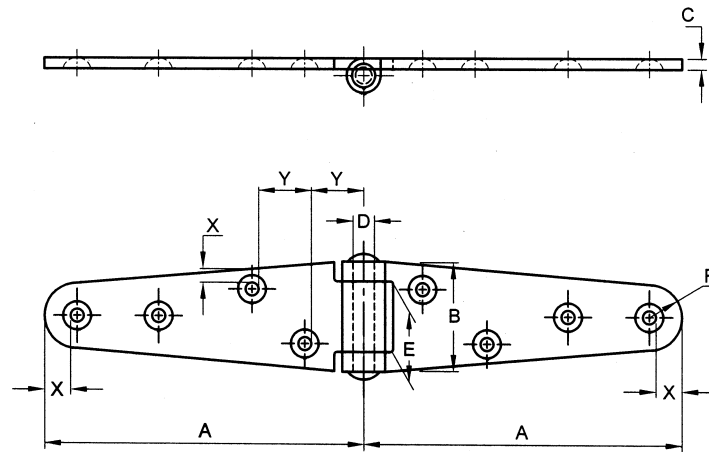

FIG. 2 MILD STEEL STRAP HINGES

8.2 Each package shall be labelled showing the following particulars:

- a) Type of hinge,
- b) Size of hinge,
- c) Quantity of hinges, and
- d) Name of the manufacturer or trade-mark.

9 SAMPLING AND CRITERION FOR CONFORMITY

The scale of sampling and criterion for conformity of tee and strap hinges shall be as given in Annex A.

10 MARKING

10.1 Each Tee and strap hinge shall be marked with the following:

- a) Manufacturers name or his trade-mark,
- b) Type of hinge, and
- c) Size of hinge.

10.2 BIS Certification Marking

The hinges may also be marked with the Standard Mark.

10.2.1 The use of the Standard Mark is governed by the provisions of the *Bureau of Indian Standards Act, 1986* and the Rules and Regulations made thereunder. The details of conditions under which the license for the use of the Standard Mark may be granted to manufacturers or producers may be obtained from the Bureau of Indian Standards.

Table 2 Dimensions of Light Weight Tee Hinges (Type 1)
(Clauses 5.1 and 6)

Sl No.	Size	Dimensions mm										Number of Holes in Tee	Number of Holes in Strap	Size Designation of Countersunk Head Wood Screws	Number of Holes in Tee	X mm Min	Y mm Min
		A (3)	B (4)	C (5)	D (6)	E (7)	F (8)	G (9)	R (10)	(11)	(12)						
i)	75	75 ± 2	60 ± 1	20 ± 1.5	2.80 ± 0.05	1.60 ± 0.10	25 ± 2	20 ± 1	5 ± 1	6	3	3	4	10			
ii)	100	100 ± 2	65 ± 1	20 ± 1.5	3.15 ± 0.05	1.60 ± 0.10	30 ± 2	25 ± 1	6 ± 1	6	3	3	4	10			
iii)	125	125 ± 2	65 ± 1	20 ± 1.5	3.15 ± 0.05	1.60 ± 0.10	30 ± 2	25 ± 1	6 ± 1	6	5	3	4	10			
iv)	150	150 ± 2	65 ± 1	20 ± 1.5	3.15 ± 0.05	1.60 ± 0.10	30 ± 2	25 ± 1	6 ± 1	6	5	3	4	10			
v)	200	200 ± 2	70 ± 1	25 ± 1.5	4.00 ± 0.05	1.60 ± 0.10	30 ± 2	25 ± 1	8 ± 1	8	5	3	5	10			
vi)	250	250 ± 2	80 ± 1	30 ± 1.5	4.00 ± 0.05	2.00 ± 0.10	35 ± 2	30 ± 1	8 ± 1	8	6	3	6	15			
vii)	300	300 ± 2	100 ± 1	30 ± 1.5	5.00 ± 0.05	2.00 ± 0.10	40 ± 2	35 ± 1	8 ± 1	8	6	3	8	20			
viii)	350	350 ± 2	105 ± 1	35 ± 1.5	5.00 ± 0.05	2.00 ± 0.10	50 ± 2	45 ± 1	9 ± 1	9	7	4	8	20			
ix)	400	400 ± 2	120 ± 1	35 ± 1.5	5.60 ± 0.06	2.24 ± 0.10	50 ± 2	45 ± 1	9 ± 1	9	7	4	8	25			

NOTES

1 In straight cut light weight tee hinges dimension *F* shall be followed through.

2 Dimensions *R*, *X* and *Y* are for reference only and can be modified to suit requirement of the purchaser.

Table 3 Dimensions of Light Weight Tee Hinges (Type 2)
(Clauses 5.1 and 6)

Sl No.	Size	Dimensions mm										Number of Holes in Tee	Number of Holes in Strap	Size Designation of Countersunk Head Wood Screws	Number of Holes in Tee	X mm Min	Y mm Min
		A (3)	B (4)	C (5)	D (6)	E (7)	F (8)	G (9)	R (10)	(11)	(12)						
i)	100	100 ± 2	65 ± 1	18 ± 1.5	4.0 ± 0.05	1.2 ± 0.10	25 ± 2	24 ± 1	6 ± 1	6	3	3	4	10			
ii)	150	150 ± 2	70 ± 1	20 ± 1.5	4.0 ± 0.05	1.4 ± 0.10	35 ± 2	24 ± 1	6 ± 1	6	3	4	5	10			
iii)	200	200 ± 2	80 ± 1	25 ± 1.5	4.5 ± 0.05	1.4 ± 0.10	35 ± 2	28 ± 1	8 ± 1	6	3	4	5	10			
iv)	250	250 ± 2	80 ± 1	25 ± 1.5	4.5 ± 0.05	1.4 ± 0.10	35 ± 2	28 ± 1	8 ± 1	6	3	4	6	15			
v)	300	300 ± 2	100 ± 1	25 ± 1.5	5.6 ± 0.05	1.6 ± 0.10	45 ± 2	35 ± 1	8 ± 1	6	3	4	8	20			

NOTES

1 In straight cut light weight tee hinges dimension *F* shall be followed through.

2 Dimensions *R*, *X* and *Y* are for reference only and can be modified to suit requirement of the purchaser.

Table 4 Dimensions of Medium Weight Tee Hinges (Type 1)
(Clauses 5.1 and 6)

Sl No.	Size	Dimensions mm												
		A (3)	B (4)	C (5)	D (6)	E (7)	F (8)	G (9)	R (10)	Size Designation of Countersunk Head Wood Screws (11)	Number of Holes in Strap (12)	Number of Holes in Tee (13)	X mm Min (14)	Y mm Min (15)
i)	75	75 ± 2	65 ± 1	20 ± 1.5	3.15 ± 0.05	1.60 ± 0.10	25 ± 2	20 ± 1	5 ± 1	6	3	3	4	10
ii)	100	100 ± 2	70 ± 1	20 ± 1.5	3.15 ± 0.05	1.60 ± 0.10	30 ± 2	25 ± 1	6 ± 1	6	3	3	4	10
iii)	125	125 ± 2	75 ± 1	25 ± 1.5	4.00 ± 0.05	1.60 ± 0.10	35 ± 2	30 ± 1	6 ± 1	8	4	3	4	10
iv)	150	150 ± 2	75 ± 1	25 ± 1.5	4.00 ± 0.05	1.60 ± 0.10	40 ± 2	35 ± 1	6 ± 1	8	4	3	4	10
v)	200	200 ± 2	90 ± 1	25 ± 1.5	5.00 ± 0.05	2.00 ± 0.10	45 ± 2	40 ± 1	8 ± 1	8	4	3	5	10
vi)	250	250 ± 3	100 ± 1	30 ± 1.5	5.60 ± 0.06	2.24 ± 0.10	45 ± 2	40 ± 1	8 ± 1	9	5	3	6	15
vii)	300	300 ± 3	115 ± 1	30 ± 1.5	6.30 ± 0.06	2.24 ± 0.10	50 ± 2	45 ± 1	8 ± 1	9	5	3	8	20
viii)	350	350 ± 3	120 ± 1	35 ± 1.5	6.30 ± 0.06	2.50 ± 0.10	55 ± 2	50 ± 1	8 ± 1	10	7	4	8	20
ix)	400	400 ± 3	135 ± 1	35 ± 1.5	6.30 ± 0.06	2.50 ± 0.10	60 ± 2	55 ± 1	8 ± 1	10	7	4	8	20
x)	450	450 ± 3	140 ± 1	45 ± 1.5	8.00 ± 0.06	2.50 ± 0.10	60 ± 2	55 ± 1	9 ± 1	12	7	4	10	25
xi)	500	500 ± 3	150 ± 1	50 ± 1.5	10.00 ± 0.06	3.15 ± 0.10	65 ± 2	60 ± 1	9 ± 1	12	8	4	10	25

NOTES

- 1 In straight cut medium weight tee hinges dimension *F* shall be followed through.
- 2 Dimensions *R*, *X* and *Y* are for reference only and can be modified to suit requirement of the purchaser.

Table 5 Dimensions of Medium Weight Tee Hinges (Type 2)
(Clauses 5.1 and 6)

Sl No.	Size	Dimensions mm												
		A (3)	B (4)	C (5)	D (6)	E (7)	F (8)	G (9)	R (10)	Size Designation of Countersunk Head Wood Screws (11)	Number of Holes in Strap (12)	Number of Holes in Tee (13)	X mm Min (14)	Y mm Min (15)
i)	100	100 ± 2	65 ± 1	20 ± 1.5	4.0 ± 0.05	1.50 ± 0.10	30 ± 2	25 ± 1	6 ± 1	8	3	3	4	10
ii)	125	125 ± 2	75 ± 1	25 ± 1.5	4.5 ± 0.05	1.60 ± 0.10	35 ± 2	29 ± 1	8 ± 1	8	3	3	4	10
iii)	150	150 ± 2	75 ± 1	25 ± 1.5	4.5 ± 0.05	1.60 ± 0.10	35 ± 2	30 ± 1	8 ± 1	8	3	3	4	10
iv)	200	200 ± 2	80 ± 1	25 ± 1.5	5.6 ± 0.06	1.70 ± 0.10	40 ± 2	35 ± 1	9 ± 1	8	3	4	6	15
v)	250	250 ± 3	90 ± 1	25 ± 1.5	5.6 ± 0.06	1.70 ± 0.10	45 ± 2	35 ± 1	9 ± 1	8	3	4	6	15
vi)	300	300 ± 3	100 ± 1	30 ± 1.5	6.3 ± 0.06	1.70 ± 0.10	50 ± 2	40 ± 1	9 ± 1	8	3	4	8	20
vii)	350	350 ± 3	115 ± 1	30 ± 1.5	6.3 ± 0.06	1.70 ± 0.10	55 ± 2	48 ± 1	10 ± 1	8	4	4	8	20
viii)	380	380 ± 3	115 ± 1	30 ± 1.5	6.3 ± 0.06	1.80 ± 0.10	55 ± 2	48 ± 1	10 ± 1	8	4	5	8	20
ix)	400	400 ± 3	125 ± 1	35 ± 1.5	7.0 ± 0.06	2.20 ± 0.10	55 ± 2	48 ± 1	10 ± 1	10	4	5	8	25
x)	450	450 ± 3	130 ± 1	35 ± 1.5	8.0 ± 0.06	2.20 ± 0.10	55 ± 2	48 ± 1	12 ± 1	10	4	5	10	25
xi)	500	500 ± 3	150 ± 1	50 ± 1.5	10.0 ± 0.06	2.30 ± 0.10	60 ± 2	60 ± 1	12 ± 1	12	4	6	10	25
xii)	600	600 ± 3	150 ± 1	50 ± 1.5	10.0 ± 0.06	2.30 ± 0.10	70 ± 2	60 ± 1	12 ± 1	12	4	6	10	25

NOTES

- 1 In straight cut medium weight tee hinges dimension *F* shall be followed through.
- 2 Dimension *R*, *X* and *Y* are for reference only and can be modified to suit requirement of the purchaser.

Table 6 Dimensions of Heavy Weight Tee Hinges (Type 1)
(Clauses 5.1 and 6)

Sl No.	Size	Dimensions mm										Number of Holes in Strap (12)	Number of Holes in Tee (13)	X mm Min (14)	Y mm Min (15)
		A (3)	B (4)	C (5)	D (6)	E (7)	F (8)	G (9)	R (10)	Size Designation of Countersunk Head Wood Screws (11)					
i)	150	150 ± 2	100 ± 1	30 ± 2	8 ± 0.06	3.15 ± 0.10	50 ± 2	40 ± 1	8 ± 1	10	4	3	6	10	
ii)	200	200 ± 2	115 ± 1	40 ± 2	10 ± 0.06	3.15 ± 0.10	55 ± 2	45 ± 1	8 ± 1	10	4	3	6	10	
iii)	250	250 ± 2	115 ± 1	40 ± 2	10 ± 0.06	3.15 ± 0.10	60 ± 2	50 ± 1	8 ± 1	10	4	4	8	20	
iv)	300	300 ± 2	125 ± 1	45 ± 2	10 ± 0.06	3.15 ± 0.10	60 ± 2	50 ± 1	9 ± 1	10	6	4	8	20	
v)	350	350 ± 4	125 ± 1	45 ± 2	10 ± 0.06	3.15 ± 0.10	60 ± 2	50 ± 1	9 ± 1	10	6	4	8	20	
vi)	400	400 ± 4	135 ± 1	50 ± 2	12 ± 0.06	4.15 ± 0.10	65 ± 2	55 ± 1	9 ± 1	12	7	4	8	20	
vii)	450	450 ± 4	135 ± 1	50 ± 2	12 ± 0.06	4.15 ± 0.10	65 ± 2	55 ± 1	10 ± 1	12	7	4	10	25	
viii)	500	500 ± 4	150 ± 1	65 ± 2	12 ± 0.06	5.00 ± 0.10	70 ± 2	60 ± 1	10 ± 1	14	8	4	10	25	
ix)	600	600 ± 4	165 ± 1	70 ± 2	12 ± 0.06	5.00 ± 0.10	75 ± 2	65 ± 1	10 ± 1	14	8	4	10	25	

NOTES

1 In straight cut heavy weight tee hinges dimension *F* shall be followed through.

2 Dimensions *R*, *X* and *Y* are for reference only and can be modified to suit requirement of the purchaser.

Table 7 Dimensions of Heavy Weight Tee Hinges (Type 2)
(Clauses 5.1 and 6)

Sl No.	Size	Dimensions mm										Number of Holes in Strap (12)	Number of Holes in Tee (13)	X mm Min (14)	Y mm Min (15)
		A (3)	B (4)	C (5)	D (6)	E (7)	F (8)	G (9)	R (10)	Size Designation of Countersunk Head Wood Screws (11)					
i)	100	100 ± 2	90 ± 1	30 ± 1.5	7 ± 0.06	2.24 ± 0.10	50 ± 2	44 ± 1	8 ± 1	9	3	3	6	10	
ii)	150	150 ± 2	90 ± 1	30 ± 1.5	7 ± 0.06	2.24 ± 0.10	50 ± 2	44 ± 1	8 ± 1	9	3	3	6	10	
iii)	200	200 ± 2	100 ± 1	35 ± 1.5	7 ± 0.06	2.24 ± 0.10	50 ± 2	44 ± 1	8 ± 1	9	3	4	6	10	
iv)	250	250 ± 2	100 ± 1	38 ± 1.5	7 ± 0.06	2.24 ± 0.10	50 ± 2	44 ± 1	8 ± 1	10	3	4	8	20	
v)	300	300 ± 2	100 ± 1	38 ± 1.5	7 ± 0.06	2.24 ± 0.10	50 ± 2	44 ± 1	9 ± 1	10	4	5	8	20	
vi)	350	350 ± 4	100 ± 1	38 ± 1.5	7 ± 0.06	2.24 ± 0.10	55 ± 2	44 ± 1	9 ± 1	10	4	5	8	20	

NOTES

1 In straight cut heavy weight tee hinges dimension *F* shall be followed through.

2 Dimensions *R*, *X* and *Y* are for reference only and can be modified to suit requirement of the purchaser.

Table 8 Dimensions of Heavy Weight Tee Hinges (Type 3)
(Clauses 5.1 and 6)

Sl No.	Size	Dimensions mm							Size Designation of Countersunk Head Wood Screws (11)	Number of Holes in Strap (12)	Number of Holes in Tee (13)	X mm Min (14)	Y mm Min (15)
(1)	(2)	A (3)	B (4)	C (5)	D (6)	E (7)	F (8)	G (9)	R (10)				
i)	350	350 ± 4	145 ± 1	48 ± 2	10 ± 0.08	3.15 ± 0.10	75 ± 2	68 ± 1	14	4	5	8	20
ii)	400	400 ± 4	160 ± 1	48 ± 2	10 ± 0.08	3.15 ± 0.10	75 ± 2	68 ± 1	14	4	5	8	20
iii)	450	450 ± 4	175 ± 1	48 ± 2	10 ± 0.08	3.15 ± 0.10	85 ± 2	78 ± 1	14	4	5	10	25

NOTES

1 In straight cut heavy weight tee hinges dimension *F* shall be followed through.

2 Dimensions *R*, *X* and *Y* are for reference only and can be modified to suit requirement of the purchaser.

Table 9 Dimensions of Light Weight Strap Hinges
(Clauses 5.1 and 6)

Sl No.	Size	Dimensions mm							Size Designation of Countersunk Head Wood Screws (9)	Number of Holes in Strap (10)	X mm Min (11)	Y mm Min (12)
(1)	(2)	A (3)	B (4)	C (5)	D (6)	E (7)	R (8)					
i)	75	75 ± 2	25 ± 1	1.60 ± 0.10	2.80 ± 0.05	10 ± 1	5 ± 1	6	3	4	10	
ii)	100	100 ± 2	30 ± 1	1.60 ± 0.10	3.15 ± 0.05	15 ± 1	6 ± 1	6	3	4	10	
iii)	125	125 ± 2	30 ± 1	1.60 ± 0.10	3.15 ± 0.05	15 ± 1	6 ± 1	6	4	4	10	
iv)	150	150 ± 2	30 ± 1	1.60 ± 0.10	3.15 ± 0.05	15 ± 1	6 ± 1	6	4	4	10	
v)	200	200 ± 2	30 ± 1	1.60 ± 0.10	4.00 ± 0.05	15 ± 1	8 ± 1	8	4	4	20	
vi)	250	250 ± 2	35 ± 1	2.00 ± 0.10	4.00 ± 0.05	15 ± 1	8 ± 1	8	5	5	20	
vii)	300	300 ± 2	40 ± 1	2.00 ± 0.10	5.00 ± 0.05	20 ± 1	8 ± 1	8	5	5	25	
viii)	350	350 ± 2	50 ± 1	2.00 ± 0.10	5.00 ± 0.05	25 ± 1	8 ± 1	9	7	7	25	
ix)	400	400 ± 2	50 ± 1	2.24 ± 0.10	5.00 ± 0.05	25 ± 1	8 ± 1	9	7	8	25	

Table 10 Dimensions of Medium Weight Strap Hinges (Type 1)
(Clauses 5.1 and 6)

SI No.	Size	Dimensions mm					Size Designation of Countersunk Head Wood Screws (9)	Number of Holes in Strap (10)	X mm Min (11)	Y mm Min (12)
		A (3)	B (4)	C (5)	D (6)	E (7)				
(1)	(2)									
i)	75	75 ± 2	25 ± 1	1.60 ± 0.10	3.15 ± 0.05	10 ± 1	5 ± 1	3	4	10
ii)	100	100 ± 2	30 ± 1	1.60 ± 0.10	3.15 ± 0.05	15 ± 1	6 ± 1	3	4	10
iii)	125	125 ± 2	35 ± 1	1.60 ± 0.10	4.00 ± 0.05	15 ± 1	6 ± 1	4	4	10
iv)	150	150 ± 2	40 ± 1	1.60 ± 0.10	4.00 ± 0.05	20 ± 1	6 ± 1	4	4	10
v)	200	200 ± 2	45 ± 1	2.00 ± 0.10	5.00 ± 0.05	20 ± 1	8 ± 1	4	6	20
vi)	250	250 ± 2	45 ± 1	2.24 ± 0.10	5.60 ± 0.05	20 ± 1	8 ± 1	5	6	20
vii)	300	300 ± 2	50 ± 1	2.24 ± 0.10	6.30 ± 0.05	25 ± 1	8 ± 1	5	6	20
viii)	350	350 ± 2	55 ± 1	2.50 ± 0.10	6.30 ± 0.05	25 ± 1	8 ± 1	7	8	25
ix)	400	400 ± 2	60 ± 1	2.50 ± 0.10	6.30 ± 0.05	30 ± 1	8 ± 1	7	8	25
x)	450	450 ± 2	60 ± 1	2.50 ± 0.10	8.00 ± 0.05	30 ± 1	9 ± 1	7	8	25
xi)	500	500 ± 2	65 ± 1	3.15 ± 0.10	10.00 ± 0.05	30 ± 1	9 ± 1	8	10	30

Table 11 Dimensions of Medium Weight Strap Hinges (Type 2)
(Clauses 5.1 and 6)

SI No.	Size	Dimensions mm					Size Designation of Countersunk Head Wood Screws (9)	Number of Holes in Strap (10)	X mm Min (11)	Y mm Min (12)
		A (3)	B (4)	C (5)	D (6)	E (7)				
(1)	(2)									
i)	100	100 ± 2	35 ± 1	1.6 ± 0.10	4.50 ± 0.05	15 ± 1.0	6 ± 1	3	4	10
ii)	150	150 ± 2	45 ± 1	1.9 ± 0.10	6.30 ± 0.06	20 ± 1.0	8 ± 1	4	4	10
iii)	200	200 ± 2	45 ± 1	2.0 ± 0.10	6.30 ± 0.06	20 ± 1.0	8 ± 1	4	6	20
iv)	250	250 ± 2	55 ± 1	2.5 ± 0.10	6.30 ± 0.06	30 ± 1.0	12 ± 1	5	6	20
v)	300	300 ± 2	65 ± 1	2.8 ± 0.10	8.00 ± 0.06	30 ± 1.0	12 ± 1	5	6	20

Table 12 Dimensions of Heavy Weight Strap Hinges
(Clauses 5.1 and 6)

Sl No.	Size	Dimensions mm						Size Designation of Countersunk Head Wood Screws	Number of Holes in Strap	X mm Min	Y mm Min
(1)	(2)	A (3)	B (4)	C (5)	D (6)	E (7)	R (8)	(9)	(10)	(11)	(12)
i)	150 ± 2	150 ± 2	50 ± 1	3.15 ± 0.10	8 ± 0.06	25 ± 1	8 ± 1	10	4	6	20
ii)	200 ± 2	200 ± 2	55 ± 1	3.15 ± 0.10	10 ± 0.06	25 ± 1	8 ± 1	10	4	8	20
iii)	250 ± 2	250 ± 2	60 ± 1	3.15 ± 0.10	10 ± 0.06	30 ± 1	8 ± 1	10	5	8	20
iv)	300 ± 2	300 ± 2	60 ± 1	3.15 ± 0.10	10 ± 0.06	30 ± 1	9 ± 1	10	6	8	20
v)	350 ± 2	350 ± 2	60 ± 1	3.15 ± 0.10	10 ± 0.06	30 ± 1	9 ± 1	10	6	10	25
vi)	400 ± 2	400 ± 2	65 ± 1	4.00 ± 0.10	12 ± 0.06	30 ± 1	9 ± 1	12	7	10	25
vii)	450 ± 2	450 ± 2	65 ± 1	4.00 ± 0.10	12 ± 0.06	30 ± 1	10 ± 1	12	7	10	25
viii)	500 ± 2	500 ± 2	70 ± 1	5.00 ± 0.10	12 ± 0.06	35 ± 1	10 ± 1	14	8	10	25
ix)	600 ± 2	600 ± 2	75 ± 1	5.00 ± 0.10	12 ± 0.06	35 ± 1	10 ± 1	14	8	10	25

ANNEX A

(Clause 9)

SAMPLING AND CRITERION FOR CONFORMITY

A-1 LOT

In a consignment, all hinges (tee and strap) of the same type and size and manufactured from similar materials under identical conditions of manufacture at the same time shall be grouped together to constitute a lot.

A-2 LOT SIZE AND SAMPLE SIZE

A-2.1 Lot Size

The number of hinges to be selected from a lot shall depend on the size of the lot and shall be in accordance with col 2 and 3 of Table 13.

A-2.2 Sample Size

Hinges for testing shall be selected at random from at least 10 percent of the packages subject to a minimum of three packages, equal number of hinges being selected from each such package.

A-3 TESTS

All hinges selected as in A-2.1 shall be checked for dimensional requirements (*see 5*), defects in

manufacture (*see 6*) and finish (*see 7*). Any hinge which fails to satisfy the requirements of any one or more of the characteristics shall be considered as defective hinge.

A-4 CRITERION FOR CONFORMITY

A lot shall be considered as conforming to the requirements of this standard if the number of defective hinges, among those tested, does not exceed the corresponding number given in col 4 of Table 13.

Table 13 Scale of Sampling and Criterion for Conformity

(Clauses A-2 and A-4)

SI No. (1)	Lot Size (2)	Sample Size (3)	Permissible Number of Defective Hinges (4)
i)	Up to 200	15	0
ii)	201–300	20	1
iii)	301–500	30	2
iv)	501–800	40	2
v)	801 and above	55	3

ANNEX B

(Foreword)

COMMITTEE COMPOSITION

Builder's Hardware Sectional Committee, CED 15

Organization

1421, Sector A, Pocket B & C, Vasant Kunj, New Delhi 110070

Allied Anodisers, Kolkata

Appex Association of DDA Colonies (REGD), Delhi

Argent Industries, New Delhi

Builders Association of India, Jamshedpur

Building Materials & Technology Promotion Council, New Delhi

Central Building Research Institute, Roorkee

Representative(s)

SHRI B. MAJUMDAR (*Chairman*)

SHRI SUSHIL TAWAR

SHRI R. P. AGRAWAL

SHRI R. R. SHARMA (*Alternate*)

SHRI ANIL CHADHA

SHRIMATI VANITA CHADHA (*Alternate*)

SHRI RAJ PAL AURORA

SHRI H. S. PASRICHA (*Alternate*)

SHRI B. ANIL KUMAR

SHRI V. K. SETHI (*Alternate*)

SHRI D. K. GAUTAM

SHRI S. K. NEGI (*Alternate*)

IS 206 : 2010

<i>Organization</i>	<i>Representative(s)</i>
Central Public Works Department, New Delhi	SHRI SURESH KUMAR SHRI MAYANK K. TILAK (<i>Alternate</i>)
Construction Industries Development Council, New Delhi	SHRI P. R. SWARUP SHRI RAJEEV JAIN (<i>Alternate</i>)
D. P. Garg & Company, Noida	SHRI S. M. GARG SHRI R. C. MALHOTRA (<i>Alternate</i>)
Delhi Development Authority, New Delhi	CHIEF ENGINEER (NZ) SUPERINTENDING ENGINEER (P) NZ (<i>Alternate</i>)
Engineer-in-Chief's Branch, New Delhi	SHRI S. K. GUPTA SHRI P. MAKHIJANI (<i>Alternate</i>)
Garnish Traders, New Delhi	SHRI H. S. SETHI SHRIMATI HARMEET SETHI (<i>Alternate</i>)
Godrej & Boyce Manufacturing Co Limited, Mumbai	SHRI T. S. MURALI SHRI K. N. MODI (<i>Alternate</i>)
Hindalco Industries Limited, Distt Sonbhadra	SHRI V. K. AGGARWAL SHRI S. S. SINGHVI (<i>Alternate</i>)
Indian Aluminium Company Limited, New Delhi	SHRI P. ANIL KUMAR SHRI P. A. KOHLI (<i>Alternate</i>)
Indian Institute of Architects, New Delhi	DR ABHIJIT RAY
M.C. Mowjee & Co Pvt Limited, Kolkata	SHRI SAJID MOWJEE
MECH (India) Industries, Delhi	SHRI SUDHIR BATRA SHRI RAJESH VASUDEVA (<i>Alternate</i>)
Ministry of Railways, New Delhi	REPRESENTATIVE
National Real Estate Development Council, New Delhi	BRIG (RETD) R. R. SINGH SHRI SUMIT JHA (<i>Alternate</i>)
National Test House, Kolkata	DR P. KANJILAL SHRI ANIL CHOPRA (<i>Alternate</i>)
National Thermal Power Corporation Limited, New Delhi	REPRESENTATIVE
Office of the Development Commissioner (SSI), New Delhi	SHRI J. K. ARYA SHRI K. K. FUNDA (<i>Alternate</i>)
BIS Directorate General	SHRI A. K. SAINI, Scientist 'F' and Head (CED) [Representing Director General (<i>Ex-officio</i>)]

Member Secretary
SHRI J. ROY CHOWDHURY
Scientist 'E' (CED), BIS

Bureau of Indian Standards

BIS is a statutory institution established under the *Bureau of Indian Standards Act, 1986* to promote harmonious development of the activities of standardization, marking and quality certification of goods and attending to connected matters in the country.

Copyright

BIS has the copyright of all its publications. No part of these publications may be reproduced in any form without the prior permission in writing of BIS. This does not preclude the free use, in the course of implementing the standard, of necessary details, such as symbols and sizes, type or grade designations. Enquiries relating to copyright be addressed to the Director (Publications), BIS.

Review of Indian Standards

Amendments are issued to standards as the need arises on the basis of comments. Standards are also reviewed periodically; a standard along with amendments is reaffirmed when such review indicates that no changes are needed; if the review indicates that changes are needed, it is taken up for revision. Users of Indian Standards should ascertain that they are in possession of the latest amendments or edition by referring to the latest issue of 'BIS Catalogue' and 'Standards : Monthly Additions'.

This Indian Standard has been developed from Doc No. : CED 15 (7467).

Amendments Issued Since Publication

Amend No.	Date of Issue	Text Affected

BUREAU OF INDIAN STANDARDS

Headquarters:

Manak Bhavan, 9 Bahadur Shah Zafar Marg, New Delhi 110002
Telephones : 2323 0131, 2323 3375, 2323 9402 Website: www.bis.org.in

Regional Offices:

	Telephones
Central : Manak Bhavan, 9 Bahadur Shah Zafar Marg NEW DELHI 110002	{ 2323 7617 2323 3841
Eastern : 1/14 C.I.T. Scheme VII M, V. I. P. Road, Kankurgachi KOLKATA 700054	{ 2337 8499, 2337 8561 2337 8626, 2337 9120
Northern : SCO 335-336, Sector 34-A, CHANDIGARH 160022	{ 60 3843 60 9285
Southern : C.I.T. Campus, IV Cross Road, CHENNAI 600113	{ 2254 1216, 2254 1442 2254 2519, 2254 2315
Western : Manakalaya, E9 MIDC, Marol, Andheri (East) MUMBAI 400093	{ 2832 9295, 2832 7858 2832 7891, 2832 7892

Branches: AHMEDABAD. BANGALORE. BHOPAL. BHUBANESHWAR. COIMBATORE. DEHRADUN. FARIDABAD. GHAZIABAD. GUWAHATI. HYDERABAD. JAIPUR. KANPUR. LUCKNOW. NAGPUR. PARWANOO. PATNA. PUNE. RAJKOT. THIRUVANANTHAPURAM. VISAKHAPATNAM.